

VIPP13-17 PEDAL CHANGE

GUIDE

1

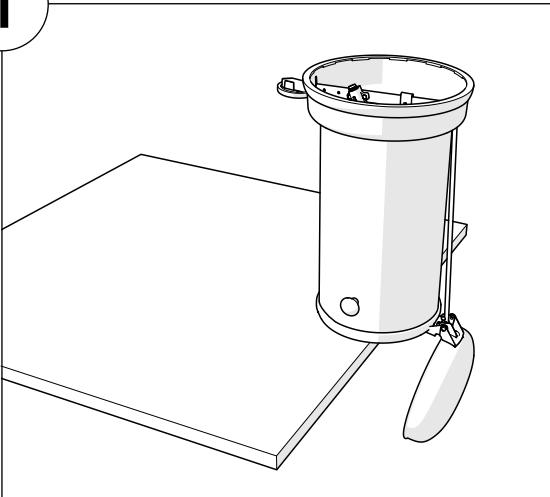

Place the bin upside down, with the lid open, on a table for an easier working position.

2

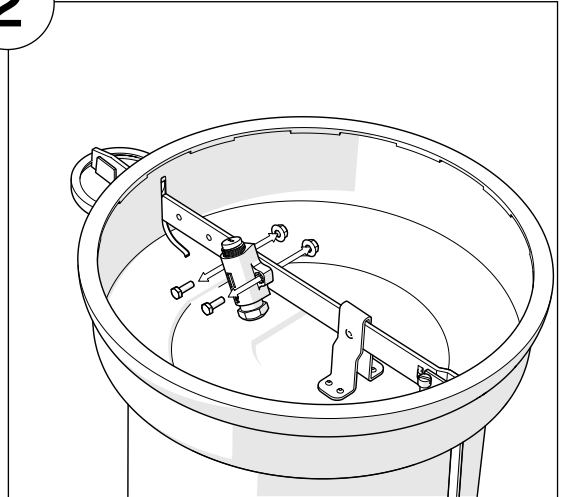

Unscrew the damper, using a wrench.

3

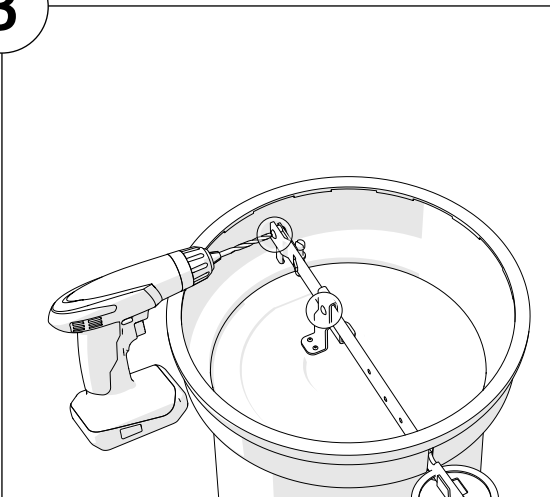

Drill out the two rivets, using a drill.

4

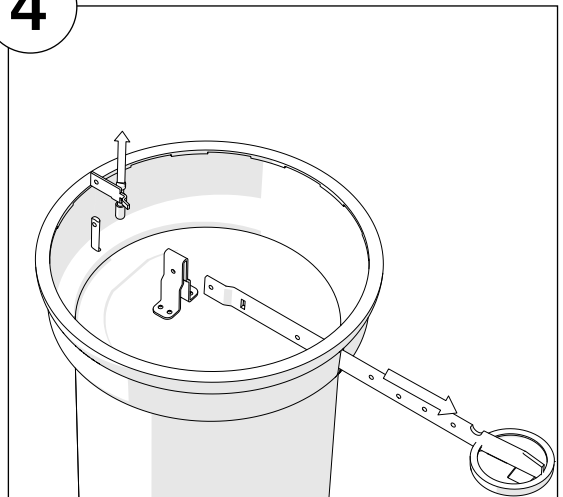

Remove the lidstop and pedal.

VIPP13-17 PEDAL CHANGE

GUIDE

5

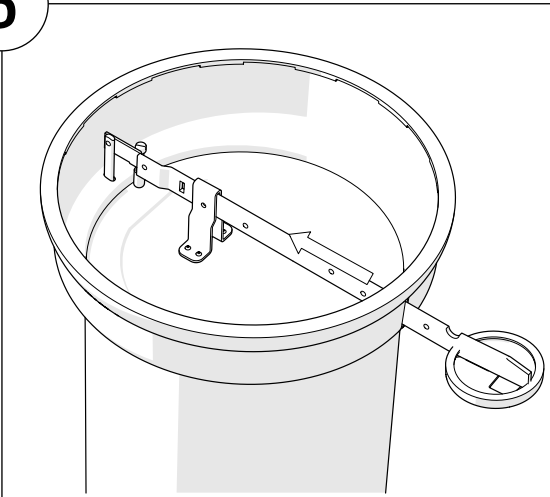

Slide the new pedal in and realign the lidstop.

6

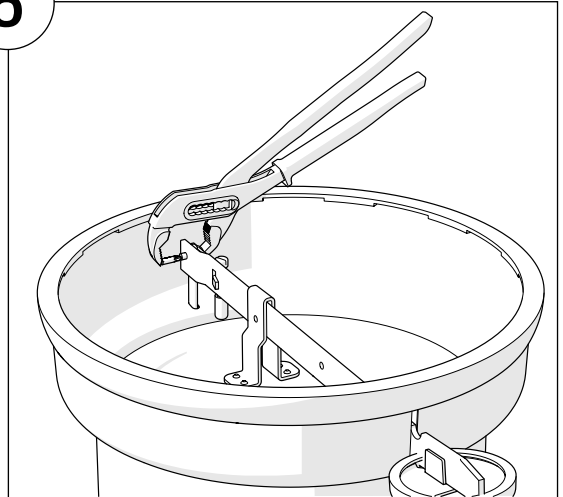

Attach the new rivets, using a bit and pliers.

7

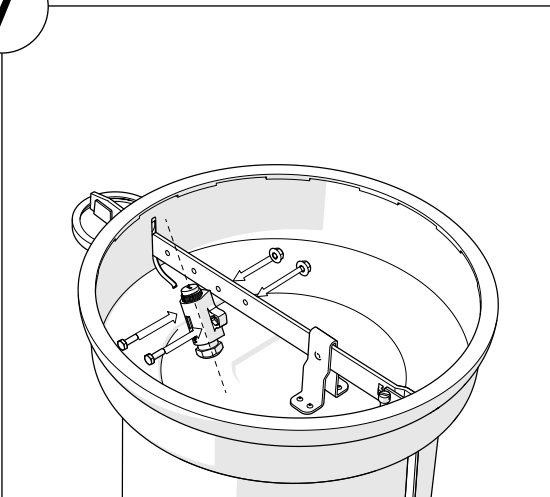

Reattach the damper, using the two cutouts closest to the middle.