

Dear Artist!

Welcome to Musikhuset Aarhus, Denmark



**musikhuset
aarhus**

Here you will find General and Technical information for
"Rytmask Sal" = The Rhythmic Hall

The Rhythmic Hall is a seated/standing venue,
with a capacity of 465 (seated) and 1000 (standing) audiences

We look forward to seeing you here in Aarhus, and please don't
hesitate to get in touch, if you have any questions



The Rhythmic Hall with standing audiences



**musikhuset
aarhus**

GENERAL INFORMATION

SEATING CAPACITY

The hall includes a telescopic grand stand, that can be pushed out, and thereby hold 465 seats (including 4 wheelchair spaces). Likewise, the podium can be moved back to make room for a standing concert with 1,000 people.

LOAD IN

At platform from Aros Allé 2A

After parking, please go to our reception round the corner at Skovgaardsgade 2C to receive a parking permit for your vehicle(s)

Access to the stage through lift from level 0

Loading platform: 0.90m

Lift door height: 2.27m

Lift door width: 1.85m

Lift depth: 4.60m

DRESSING ROOMS AND BACKSTAGE AREA

1 lounge room for 15 people, - including:

2 dressing rooms for 2 people

1 room with shower and toilet

WI-FI

Free Wireless internet. Connect to "smart Aarhus" access code through sms.

Vouchers to access the WLAN will be handed out at the Reception (please order in advance)

LAUNDRY

Free access to 2 washing machines, tumble dryer, drying cabinet, irons and ironing boards.

SMOKING

Smoking is prohibited in-house. A dedicated outdoor smoking area is available.

CONTACT

Shipping/load-in Address for "Rytmask Sal":

Musikhuset Aarhus
Skovgaardsgade 2C
DK-8000 Aarhus C
Denmark

DRIVING INSTRUCTIONS:

Address for GPS: **Street name:** Aros Allé 2A **City:** Aarhus **Country:** Denmark
Coordinates: 56°09'13.2"N 10°11'51.1"E 56.153663, 10.197516

If you arrive by truck or big coach/bus, - please avoid the inner city, and follow the map below.

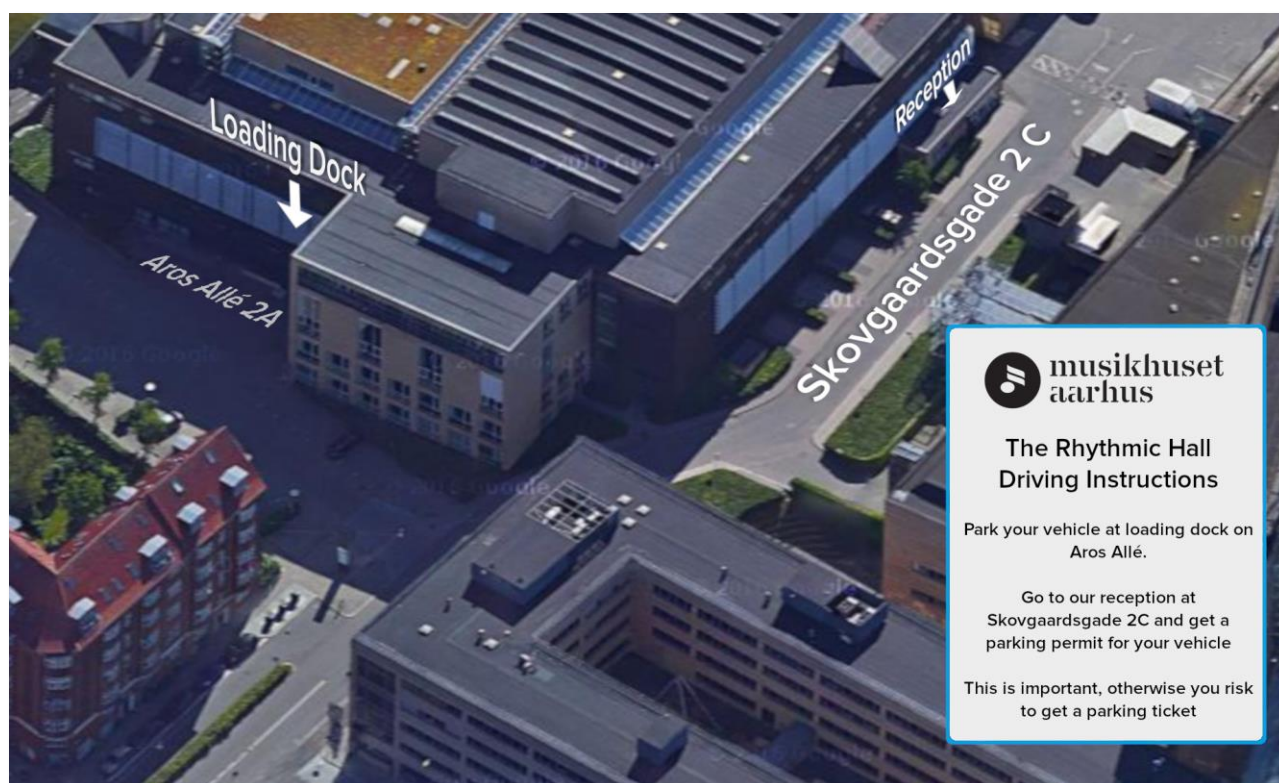
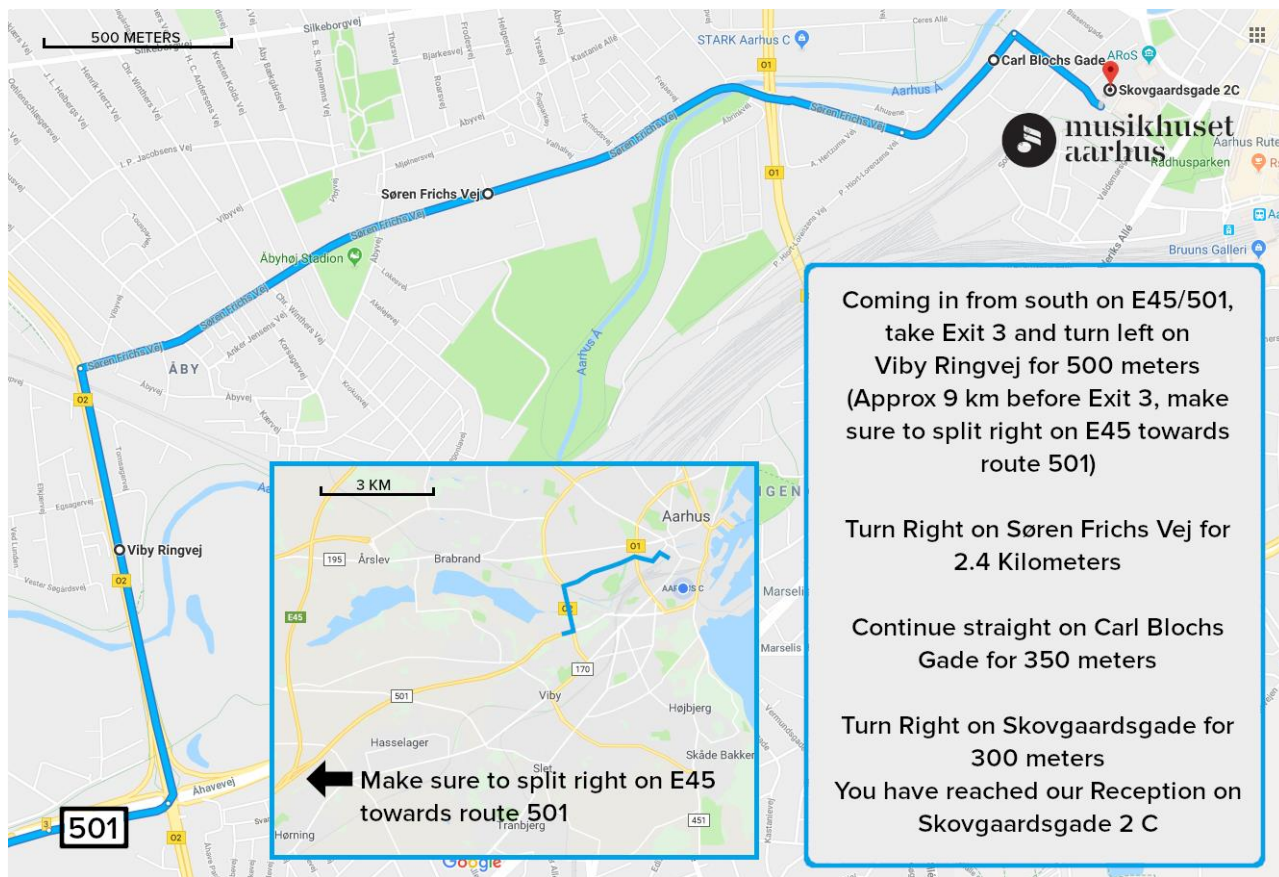

TECHNICAL SPECIFICATIONS

STAGING

STAGE DIMENSIONS

Stage made of 2 x 1 meter riser modules
Standard size: 14 x 7 m
Width up to max: 16.0m
Depth up to max: 9.0m
Standard height: 0.80m
Variable placement, height and size of stage, by request and mutual agreement
Clearance: normal stage height to flying pipe 4,40 m, from floor 5,20 meters.
Hall Floor: Ash wood floor (No screws allowed in the floor)

FLYING SYSTEM

Flying height 5.20m from the floor
8 Motorised fly bars (300 kg) - Pipe diameter: 50mm

RIGGING

6 x Electric chain hoists (250 kg)
6 x 400 cm*40cm*40cm litec truss
2 x 300 cm*40cm*40cm litec truss
Standard flown as 2 front rigs x 1700 cm

MASKING

2 full black, 8.0m x 5.1m
5 pair of legs, 2.0m x 5.1m (black)
5 borders, 13.0m x 0.8m (black)
6 side curtains, 3.0m x 4.5m (black)

RISERS/PLATFORMS

We offer a wide selection of portable Stage Risers in European (metric) standard sizes.
Available heights are: 200mm, 400mm,

AUX POWER:

1 x 3 phase 125A CEE form
4 x 3 phase 16A CEE form

AV

Projector

2 x Panasonic pt-rz990 10.000 ansilumen wuxga (16:10-1920*1200)

Lenses

ET-DLE150
ET-DLE250
ET-DLE020 ultra short throw

Screens

Upstage: Stumpf vario 5,08m x 3,25m Back Projection
Downstage: Roll-down, 5,20m x 2,92m Back Projection

SOUND

In The Rhythmic Hall, - we recommend a sound limit of 95 LAeq15 DB for Musical Theatre and 100 LAeq15 DB for Music

We have 10Eazy systems installed to measure the levels.

PA-SYSTEM (PER SIDE)

4 x d&b V8
2 x d&b V12
1 x d&b Q7 nearfill
4 x d&b V-sub
1 x d&b B-22 sub

F.O.H.

Soundcraft VI 7000
Available 1 x tc M4000
Available 1 x tc 2290

MONITOR (NO DESK)

10 x d&b M4 wedges with 10 amp sides

Mic's AKG, Beyer, DPA, Neumann, Shure, Sennheiser
DPA, BSS Line drivers

Wireless

Shure ULXD

LIGHTING

Please find detailed lighting plots for The Large Hall, WYG, PDF, DWG at: [Dropbox folder](#)

DESK

MA grandMA3 Light

DIMMERS

ETC Sensor Dimmer system
160 x 3000W

STANDARD HANGING

Fresnels

8 x ADB F101 13° – 59°, 1000W

Moving Lights

8 x High End SolaSpot 1000
12 x Robe Spiider
8 x Robe Painte

Audience Blinders

4 x Acme Blinder 2 WW

Smoke/Haze

2 x Le Maitre MVS Hazer

STAGE PLOT

Simple stage plot below

Please obtain PDF and WYG files by request to Musikhuset Aarhus

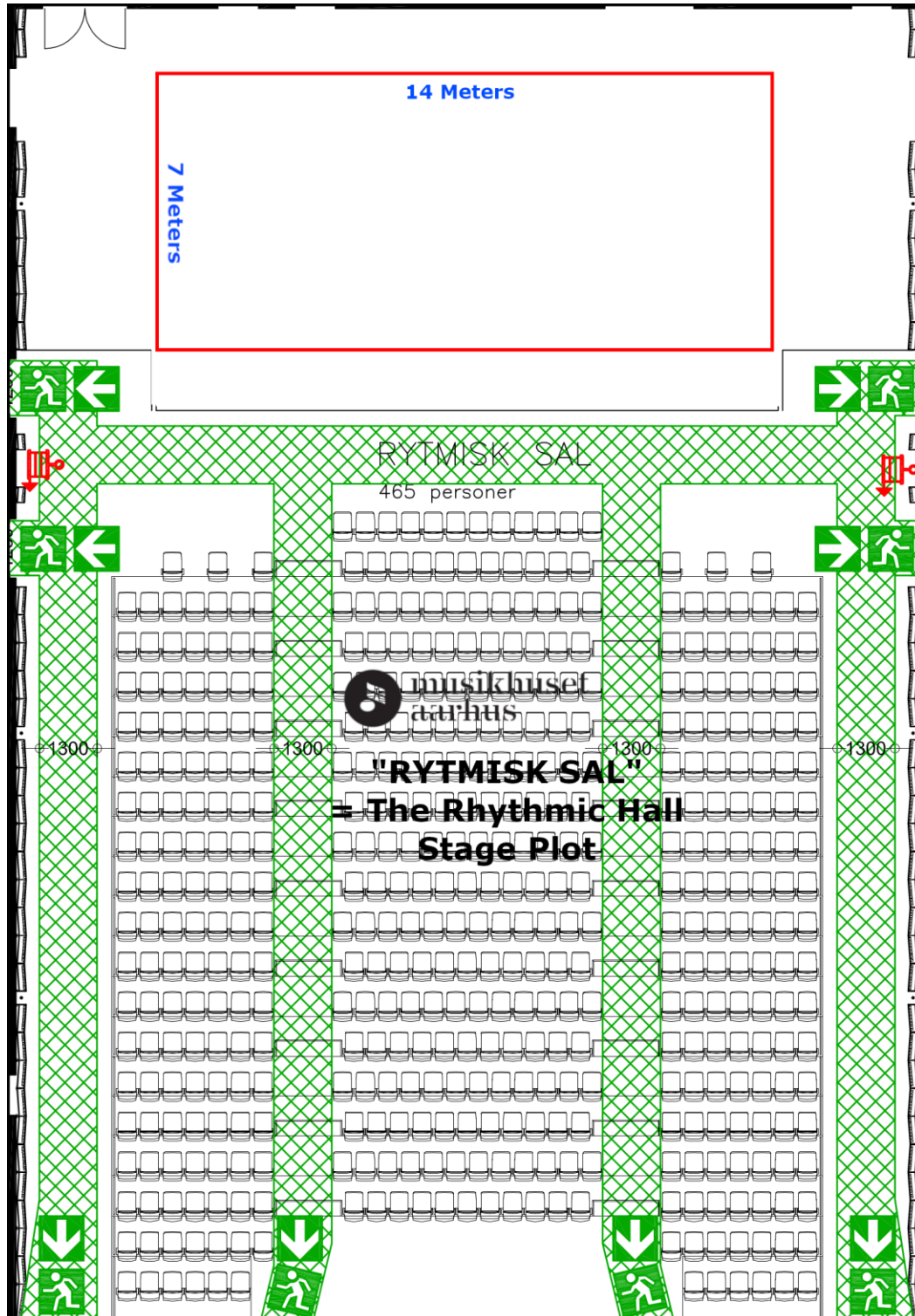

PICTURES



Stage view from audience seats



Hall with seats removed



Backstage lounge room



Dressing Room inside

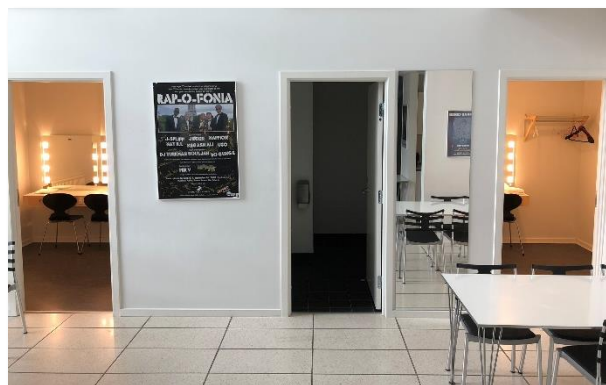

Dressing Rooms inside lounge



Backstage Lounge