



Urban Transport

IRELAND edition 2024



For over 50 years, Egis has been working with cities to develop mass transit solutions, with a focus on providing alternative modes which transform civic spaces into calmer settings, adapted to pedestrians.

Pioneers in driver less autonomous metro, Egis continues to innovate, offering our clients lower energy low impact infrastructure design. making use of lower carbon materials, which are resilient to the effects of climate change.

Together, we are building the cities of tomorrow; cities based on mobility, ecologically designed, permeable and accessible to all.

Egis is with our clients every step of the way from preliminary studies and design to deployment and operations.

The + of Egis —

A multidisciplinary culture

Engineers, urban planners, architects... all skills are brought together within the same team.

A close link with digital technology

Integrating BIM into our projects for 10 years, a digital twin to optimise infrastructure performance: we bring cutting edge technologies to support projects.

A Collaborative relationship with our clients and support throughout the project

Our teams can adapt to any organisation and are accustomed to working with partners.

Accredited and award-winning expertise

Experts in large-scale projects and in all technical disciplines, our teams are multi award-winning, including the Global Light Rail Award for "Outstanding Engineering Achievement", for our work on digital design.

Innovation at the heart of our solutions —

Creativity drives our business and informs our approach as our work on Dublin's Luas extension to Finglas illustrates. Our teams harnessed the power of digital tools and creativity to inform preliminary design and business case development, as part of the Railway Order preparation.

By embracing benchmarks like BREEAM and incorporating gender assessment techniques our team ensure that every aspect of the Line's design is meets the highest standards of sustainability, inclusivity, and functionality.

Our Solutions

BIM

The Egis design team employs BIM which enables collaborative, data-driven processes that optimise efficiency, accuracy, and sustainability throughout the project lifecycle. In Luas Finglas BIM allows for engineering design co-ordination across a blended team – client, consultant and subcontractor – and for engagement with stakeholders. The BIM model will form a digital twin of the project which will be constantly updated, alongside the project through construction into operation and maintenance.

BREEAM Assessment

In a first for transportation projects in Ireland, Luas Finglas preliminary design has been designed to meet the highest BREEAM standards. BREEAM - (Building Research Establishment Environmental Assessment Method), is an evidence-based method for assessing the application of sustainability considerations during the project life cycle.

Using the design, minutes, developed policies and innovations applied, by the entire team from client to consultant to contractors and operator, achieving BREEAM standard will certify the highest standards of sustainability in design of the project.



GENDER Lens Surveys & Assessment

Our gender assessment work, utilising techniques like Jan Ghel surveys and TII's 'Walking in Women's Shoes' policies, surveyed public spaces along the route to establish current gender usage patterns. Designs were developed to encourage greater participation from women and girls, particularly focusing on areas around stops to promote active use, community benefits, and passive security measures to reduce anti-social behavior, while also addressing age profiles and accessibility concerns.



Project Development

Our teams implement urban transport projects that transform cities into peaceful, carbon-efficient spaces. Drawing on our many years of experience and capitalising on a wide variety of projects, we are able to design, manage and commission the most complex schemes: metro, tramway, busconnects, active travel and re-imagining the urban realm

Metro



Ile-de-France | 2014 - 2031

The Grand Paris Express, a new metro for the Greater Paris region

New automatic metro system for the Paris region, including 200 km of metro, 4 new lines and 68 stations. Our commission: project management for civil engineering structures (tunnels, stations and emergency access structures) and for the infrastructure of several sections of the Grand Paris Express, spanning 35 km and 10 stations:

- the section of line 16 between Le Bourget RER and Noisy-Champs,
- the section of Lines 16 and 17 between Saint-Denis - Pleyel and Le Bourget RER,
- the extension of line 14 between Mairie de Saint-Ouen and Saint-Denis - Pleyel and
- a section of Line 15 between Saint-Denis - Pleyel and Stade de France.

Client : Société du Grand Paris

Ile-de-France | 2012 - 2022

RER E extension in Western Paris

Client : Ile-de-France Mobilités



UAE

Etihad Rail

Project management consultancy services for the development of the Stages 2 (600km) and 3 (250km) of the Emirates railway network



KSA

Riyadh Metro

Project and construction management services for 6 automated lines and 92 stations covering 177km - 60km underground, 36km over ground and 81km of viaduct sections

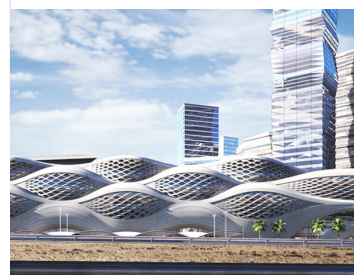

Lyon | 2015-2024

Extension of Lyon metro line B

Our scope of work: project management for civil engineering and equipment for stations and the Line's transport system, power & lighting and communications.

Client : SYTRAL Mobilités (Syndicat Mixte des Transports pour le Rhône et l'Agglomération Lyonnaise)

Rennes | 2011 - 2020

Creation of Metro Line B

Client : Société d'Économie Mixte des Transports Collectifs de l'Agglomération Rennaise



Qatar

Doha Metro

Project management for the Doha automatic metro system which comprises four lines, 76 km of track (of which 55 km underground)



Tramway

Strasbourg | 2022 - 2027

Tramway extension to Schiltigheim-Bischoheim

Our services: design and implementation

Client : Eurométropole de Strasbourg

Strasbourg | 2023 - 2028

Extension of the northern ring road

Client : Eurométropole de Strasbourg



Caen | 2023 - 2028

East-west extension

Client : Caen La Mer



Luxembourg

Extension K2 Hollerich

Preliminary design and Final Preliminary Design

Client : Luxtram



Dublin | 2021 - 2025

LUAS Finglas extension

Preliminary design and statutory processes (Phases 3&4)

Client : Transport Infrastructure Ireland



Public Bus Transport

Ireland | 2020 - 2023

BusConnects Cork: Route Option Selection studies (Phases 1&2)

The new network will involve the creation of new bus routes and improved bus frequencies to help transform the public transport network to meet anticipated growth and future demand in the region.

Client : Cork City Council & National Transport Authority

Ireland | 2020 - 2025

BusConnects Galway - Dublin Road: Preliminary design and statutory processes (Phases 3&4)

4km corridor of high quality pedestrian, cyclist and public transport facilities running east of Moneenageisha Junction to Doughiska Road Junction. This project is key to the delivery of the Galway Transport Strategy to provide infrastructure to reduce reliance on the private car, promote walking and cycling, and support improved frequency and journey time reliability of local bus, regional and national coach services.

Client : Galway City Council & National Transport Authority



Lyon - 2022-2026

Creation of a link between Trévoux and Lyon

Our commission: transport infrastructure and operating system, mobility engineering, engineering structures, landscape, environment, geotechnical, urban integration of PPublic Bus Transport (PBT) and Park+Rest (P+R) stations.

Client : Région Auvergne - Rhône-Alpes



Montpellier | 2022 - 2025

Installation of three new lines

Our scope of work: preliminary design studies, construction coordination and consultancy with public information assistance with public information.

Client : Montpellier Méditerranée Métropole

Urban Planning

To help decision-makers meet the growing challenges of urban mobility, we provide strategic decision-making support through the creation of scenarios, based on economic, social and ecological issues taking into account the diversity of stakeholders.



Poitiers | 2023-2025

Development of the mobility plan and information system

Our mission: to define the ten-year transport and travel strategy, and implementation of a decision support system for mobility.

Client : Grand Poitiers Communauté Urbaine

Le Havre | 2022 - 2026

Cycling-scheme studies

Our mission: to carry out technical studies, to draw up and monitor regulatory studies and the construction of works as part of the cycling plan.

Client : Communauté Urbaine Le Havre Seine Métropole



Low-emission zones

At a time when mobility and the ecological and energy transition can no longer be considered in isolation of each other. Egis contributes to improving air quality by proposing solutions to create efficient low-emission zones and reduce pollution.

Le Havre, Metz | 2022 à aujourd'hui

Preliminary studies and creation of low-emission mobility emission zones in Le Havre and Metz

Our mission: territorial diagnosis of mobility, road traffic air quality and population exposed, proposal of different scenarios, comparative analysis of the selected scenarios, in-depth analysis of the chosen scenario, proposals for implementation, and support for a wide-ranging citizen consultation.

Client : Le Havre Seine Métropole, Eurométropole de Metz

Lens-Liévin | 2023 à aujourd'hui

Feasibility and refiguration of a low-emission mobility emission zone (ZFE-M)

Our mission: regulatory study obligations, objectives and feasibility of setting up a ZFE-m in the territory, proposal of a territorial strategy for the next three years for the installation of electric vehicles and charging stations for the electric vehicles via the definition of a Master Plan for Electric Vehicle Charging.

Client : Communauté d'Agglomération de Lens-Liévin



Active Travel

Active Travel involves travelling using your own energy via sustainable means. It includes walking, wheeling, and cycling or the use of self-powered, non-motorised scooters as part of a purposeful journey. Our teams are working with Clients to create modal shift.

Ireland | 2020 - 2023

Dundalk Inner Relief Road Active Travel Project

A 4km section of cycleway along the R132 Dundalk Inner Relief Road will increase permeability, improve active travel facilities and increase overall cycle commuter safety.

Client : Louth County Council & National Transport Authority



Ireland | 2020 - 2025

Drogheda Bridge of Peace Active Travel Project

The planning for 2.2km of cycle lanes from the Bridge of Peace crossing the River Boyne, running southwards along the old Dublin Road, now the R132 and terminating at the (MacBride) Train Station.

Client : Louth County Council & National Transport Authority

Ireland | 2021 - 2025

Dun Laoghaire Living Streets

Sustainable mobility and public realm improvements in Dun Laoghaire. This project aims to make to make local streets safer and greener, communities more connected, and to keep the local economy vibrant. It improves infrastructure for pedestrians, cyclists, wheeled users and people with impaired mobility.

Client : Dun Laoghaire Rathdown County Council



Greenways

Ireland | 2022 - 2026

Ballina – Castlebar – Westport Interurban Greenway

Concept and feasibility study for a 60km route linking the three towns allowing people to cycle or walk from Westport to Ballina via Castlebar. It will act as a valuable corridor providing a safe, sustainable and healthy modal option for all users.

Client : Mayo County Council



Ireland | 2021 - 2025

Lee to Sea Greenway

A proposal for a continuous, world class, universally designed greenway along the River Lee valley and through the heart of Cork city. Walkers, runners, leisure and commuting cyclists of all ages and abilities will all be able to enjoy and benefit from the picturesque, accessible and safe greenway. We are working on the feasibility and route selection for a 20km section from Ballincollig to Rochestown.

By promoting sustainable and active travel, and alleviating vehicular congestion, this Greenway route will be a great regional asset, a tourism draw and will contribute to making Cork a more vibrant, connected, competitive and sustainable European city

Client : Cork County City



Station development and multimodal interchanges

Urban connectivity and living spaces are emblematic of low-carbon mobility. We design stations and multimodal transit hubs with pedestrians and modal shift in mind, in synergy with specialised transportation spaces. We are a team of architects, urban planners and landscape architects dedicated to the emergence of urban and inter-urban transport projects that optimise pedestrian and multimodal flows in conjunction with the design of spaces and the nature of the site.



Ile-de-France | 2014 - 2030

Development of stations on Line 16 of the Grand Paris Express

Our project management assignments: civil engineering works and infrastructure for the 10 stations on Line 16 between Saint-Denis - Pleyel and Noisy - Champs stations, and Stade-de-France station for Line 15 transfer areas for the 6 stations interconnected with RATP and National Society of the French Railways (SNCF); public spaces in the vicinity of stations to be designed to encourage intermodality between buses, cars and cycling, with fully accessible access at 6 of the 10 stations.

Client : Société du Grand Paris

Issoire | 2022 - 2024

Redevelopment of the multimodal hub and accessibility of Issoire Station

Our project management services: complete redevelopment of the square and a new parking lot, and adaptation to improve accessibility for people with reduced mobility.

Client : SNCF Gares et Connexion



Vannes | 2021 - 2027

Development of the multimodal interchange hub at Vannes station

Our project management commission:

- development of the station square, creation of dedicated bus lanes, and integration of cycle paths, creation of a new bus station and a car park and a 170-space surface parking lot.
- integration of all the mobility functions and mobility features expected of this type of development: places for people with reduced mobility, cycle parking and drop-off points
- coordination of work between the various structures (bridge, public spaces, parking lot, bus lanes).

Client : Golfe du Morbihan Vannes Agglomération

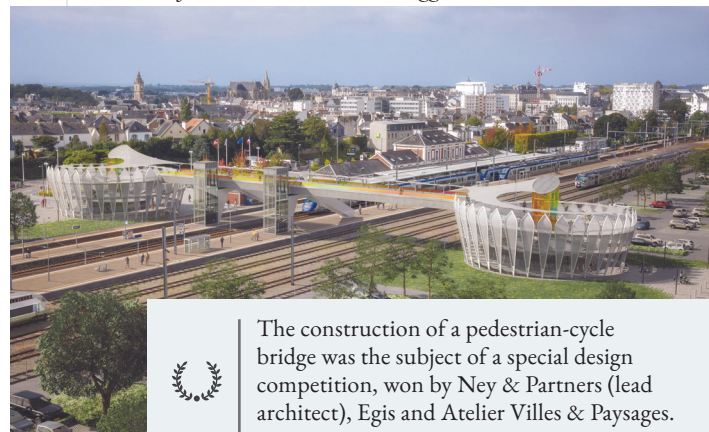

The construction of a pedestrian-cycle bridge was the subject of a special design competition, won by Ney & Partners (lead architect), Egis and Atelier Villes & Paysages.

Ireland | 2019 - 2026

N/M20 Cork to Limerick

The Preferred Transport Solution is not limited to consideration of a single mode of transport but is based upon a holistic, multi modal view to improving connectivity, safety and economic links between the cities of Cork and Limerick, and ultimately Galway.

The provision of mobility hubs is an integral element of the project and will be located close to the main junctions. They will enable effective active travel and public transport linkages to nearby communities, thereby offering greater travel choice and modal change opportunities.

Client : Limerick City & County Council with TII

General mobility studies

Feasibility or options selection, emerging preferred routes, traffic modeling, socioeconomic studies, operating studies, cycle network diagrams, studies for the implementation of Low Emission Zones (LEZ), are just some of the fields of expertise required to implement urban transport projects. Our experts can support you, whatever your needs.



Lyon | 2011 - 2025

Feasibility study for a new tramway line in Western Lyon (TEOL)

Our commission: feasibility and in-depth feasibility studies. Egis covers all the skills required in the fields of mobility, tramway infrastructures, geotechnics, tunnels, underground structures, engineering structures, architectural and urban functional design, landscape integration, environment, procedural support.

Client : SYTRAL Mobilité

Anancy | 2022 à aujourd'hui

Preliminary studies for the development of exclusive right-of-way public transport

Client : Grand Anancy



Toulouse | 2019 - 2020

Traffic and socio-economic studies for the RER metropolitan project

Our commission: project management assistance for traffic studies and socio-economic assessments, drafting of Exhibit H of the DUP files, monitoring and piloting of General Secretariat for Investment (SGPI) expertise

Client : SNCF Réseau

Lille | 2020 - 2024

Creation of four new tramway lines and two Public Bus Transport lines

Our services: technical and economic feasibility studies, urban integration, architectural and traffic studies, and support for project consultation.

Client : Métropole européenne de Lille

Ile-de-France | 2021 - 2023

Preliminary studies and establishment (Bus Bords de Marne)

Our services: preliminary studies, schematic design, public inquiry file, study of specific improvements bus operations on the ex-RN34 and resumption of studies for the studies for the Chelles-Gournay hub.

Client : Ile-de-France Mobilités



IMAGINE. CREATE. ACHIEVE.
a sustainable future



www.egis-group.com

Egis Head Office

15 avenue du Centre CS20538-Guyancourt
78286 Saint-Quentin-en-Yvelines Cedex France

Egis Ireland Office

4044 Kingswood Ave, Citywest Business Campus,
Dublin 24, D24 T6YE

Publication: April 2024
IRELAND